

## 8.主减速器总成 Main Transmission Parts

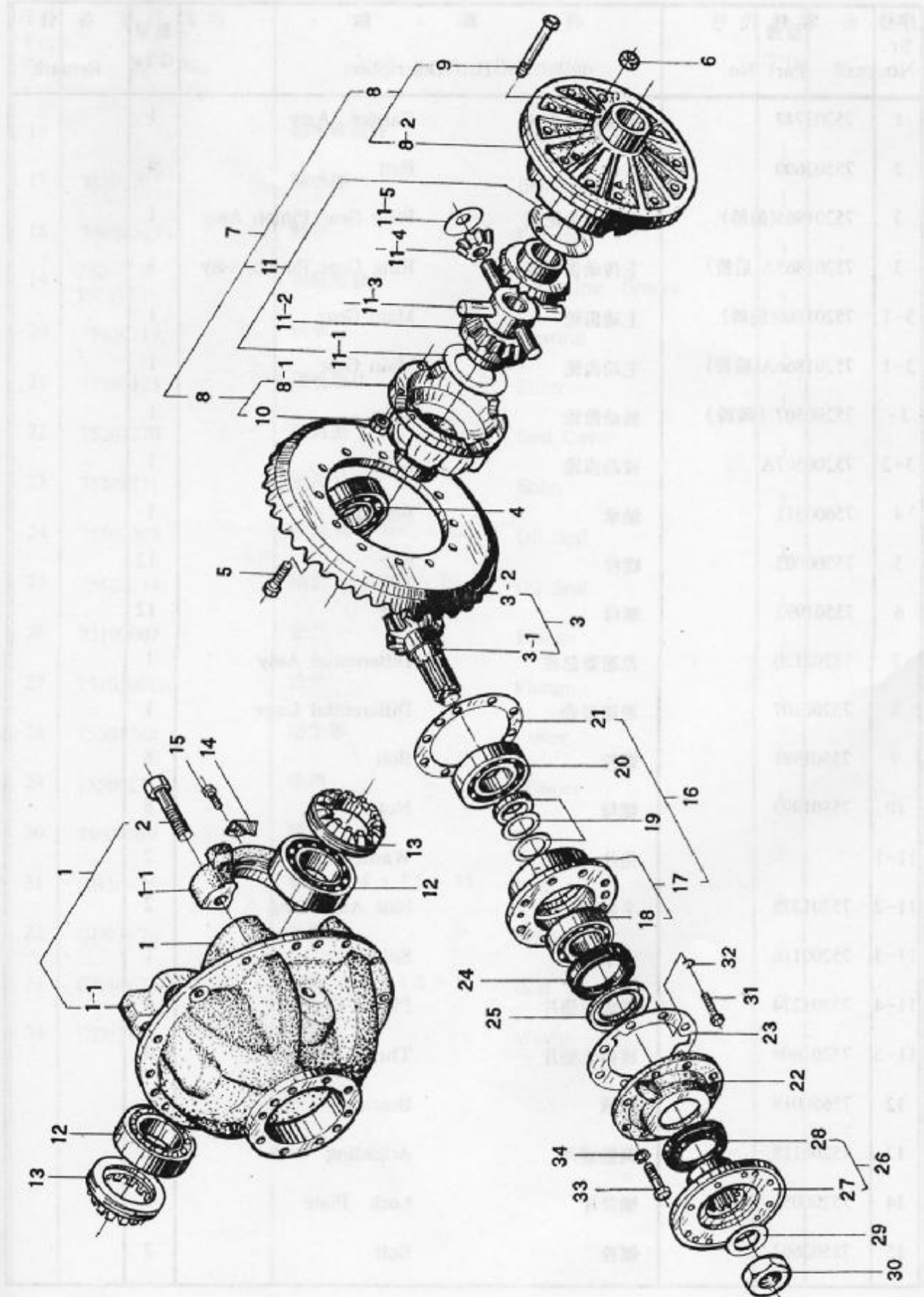

## 8.主减速器总成 Main Transmission Parts

序号 Sr. No.	零件代号 Part No.	名 称 Part Description	数量 Q'ty	备 注 Remark
1	75202749	主减器壳总成 Carrier Assy	1	
2	75502600	螺栓 Bolt	4	
3	75201865(前桥)	主传动齿轮副 Ring Gear Pinion Assy	1	
3	75201865A(后桥)	主传动齿轮副 Ring Gear Pinion Assy	1	
3-1	75201866(前桥)	主动齿轮 Main Gear	1	
3-1	75201866A(后桥)	主动齿轮 Main Gear	1	
3-	75200507 (前桥)	被动齿轮 Gear	1	
3-2	75200507A	被动齿轮 Gear	1	
4	75600311	轴承 Bearing	1	
5	75500003	螺栓 Bolt	12	
6	75501992	螺母 Nut	12	
7	75202150	差速器总成 Differential Assy	1	
8	75200107	差速器壳 Differential Cage	1	
9	75501981	螺栓 Bolt	8	
10	75501993	螺母 Nut	8	
11-1		垫片 Washer	2	
11-2	75201275	半轴齿轮 Side Axle Gear	2	
11-3	75200116	十字轴 Spider	1	
11-4	75201274	锥齿轮垫片 Pinion Gear	4	
11-5	75201609	锥齿轮垫片 Thrust Washer	4	
12	75650019	轴承 Bearing	2	
13	75200118	调整螺母 Adjusting Nut	2	
14	75200053	锁紧片 Lock Plate	2	
15	75502602	螺栓 Bolt	2	

## 8.主减速器总成 Main Transmission Parts

序号 Sr. No.	零件代号 Part No.	名 称 Part Description	数量 Q'ty	备 注 Remark
16		轴承座组件 Bearing Cage	1	
17	75201767	轴承座 Bearing Cage	1	
18	75650313	轴承 Bearing	1	
19	75201730 75201731	调整隔套 Adjusting Spacer	1	
20	75650319	轴承 Bearing	1	
21	75203123	调整垫片 Shim	1	
22	75201770	油封盖 Seal Cover	1	
23	75201771	垫片 Shim	1	
24	75502205	油封 80 × 100 × 12 Oil Seal	1	
25	75502239	隔套 80 × 100 × 10 Oil Seal	1	
26	75102007	法兰 Flange	1	
27	75102001A	法兰 Flange	1	
28	75201748	防尘罩 Cover	1	
29	75500231	垫圈 Washer	1	
30	75500269	螺母 Nut	1	
31	GB30-76	螺栓 M14 × 1.5 × 55 Bolt	1	
32	GB93-76	垫圈 14 Washer	1	
33	GB30-76	螺栓 M12 × 1.5 × 55 Bolt	7	
34	GB93-76	垫圈 Washer	7	

# 9. 轮边减速总成 Planetary Reductor

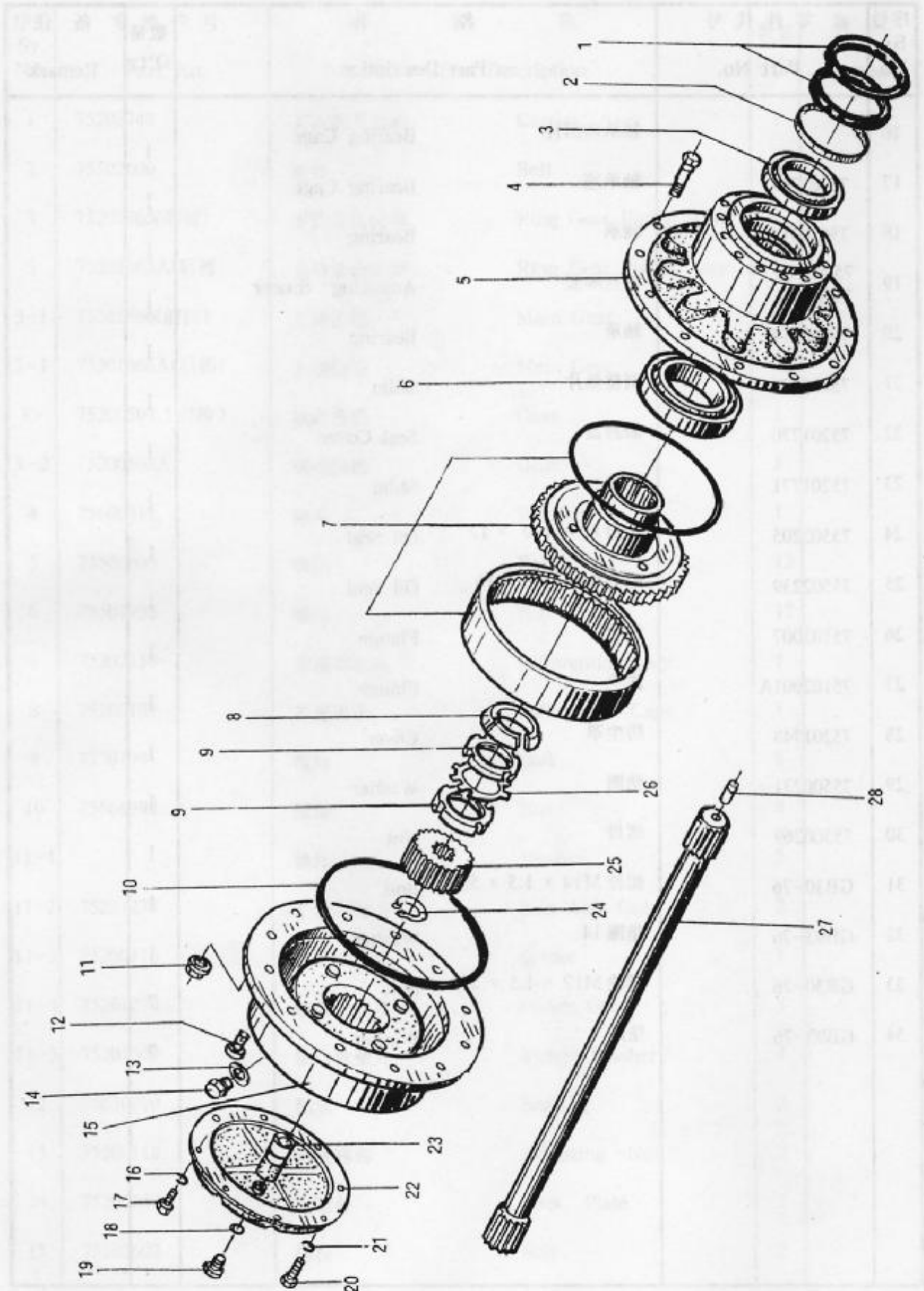

## 9. 轮边减速总成 Planetary Reductor

序号 Sr. No.	零件代号 Part No.	名 称 Part Description	数量 Q'ty	备 注 Remark	
1	HG4-692-67	油封 PD150 × 180 × 16	Oil Seal	2	
2	77000493	隔环	Spacer	1	
3	GB297-84	轴承 2007122	Bearing	1	
4	ZL40.2-9	轮钢螺栓	wheel Pin Assy	20	
5	79002002B	轮毂	Wheel Hub	1	
6	GB297-84	轴承 2007126	Bearing	1	
7	77500938	内齿圈总成	Internal Gear Assy	1	
8	76101041	锥套	Taper	1	
9	75501648	圆螺母	Lock Nut	2	
10	75501957	密封圈 F 337 × 343	Oil Seal Ring	1	
11	ZL40.2-10	轮钢螺母	Wheel Nut	20	
12	GB982-76	螺栓 M10 × 1.5 × 30	Bolt	3	
13	GB982-77	组合垫圈 12	Washer	1	
14	75500195	螺塞	Plug	1	
15	77001142	行星轮架	Planetary Pinion Carrier	1	
16	GB93-87	垫圈 10	Washer	1	
17	GB30-76	螺栓 M10 × 1.25 × 23	Bolt	1	
18	JB982-77	组合垫圈	Washer	1	
19	75500842	螺塞	Plug	1	
20	GB30-76	螺栓 M12 × 1.25 × 23	Bolt	7	
21	GB93-87	垫圈 12	Washer	7	
22	79001544	端盖	Cover	1	
23	73520042	轴衬	Bushing	1	
24	GB894-76	挡圈轮 50	Snap Ring	1	
25	79001524	太阳轮	Sun Gear	1	
26	GB858-76	止退垫 85	Washer	1	
27	79000131B	半轴	Axle Shaft	1	
28	77000044	调整销	Adjusting Pin	1	

# 10. 变速箱系统 Transmission System

